



**TRANSPORTATION CABINET**

Frankfort, Kentucky 40622  
www.transportation.ky.gov/

**Steven L. Beshear**  
Governor

**Michael W. Hancock, P.E.**  
Secretary

May 27, 2014

CALL NO. 402  
CONTRACT ID NO. 142130  
ADDENDUM # 3

Subject: Bell County, 007GR14P050-FD05 & FD04  
Letting May 30, 2014

- (1) Revised - Special Notes - Pages 13-18 of 112
- (2) Added - Special Notes - Pages 18(a)-18(h) of 112
- (3) Revised - Detail Sheets - Pages 71-72 of 112
- (4) Revised - Bid Items - Pages 112 of 112

Proposal revisions are available at <http://transportation.ky.gov/Construction-Procurement/>.

If you have any questions, please contact us at 502-564-3500.

Sincerely,

A handwritten signature in blue ink that reads "Diana Castle Radcliffe".

Diana Castle Radcliffe  
Director  
Division of Construction Procurement

DR:ks  
Enclosures



An Equal Opportunity Employer M/F/D

## SPECIAL NOTE FOR JPC INTERSECTION PAVEMENT

---

### I. DESCRIPTION

Except as specified herein, construct Jointed Plain Concrete (JPC) intersection pavement in accordance with the Department's Standard and Supplemental Specifications, Special Provisions and Special Notes, and Standard and Sepia Drawings, current editions, and as directed by the Engineer. Section references are to the Standard Specifications. Furnish all materials, equipment, labor, and incidentals for:

- (1) Removing asphalt and/or concrete pavement and replacing with JPC Pavement; (2) Maintaining and controlling traffic; and (3) All other work specified as part of this contract.

### II. MATERIALS

The Department will sample and test all materials according to the Department's sampling Manual. Make the materials available for sampling a sufficient time in advance of their use, to allow for the necessary time for testing, unless otherwise specified in these notes.

**A. Maintain and Control Traffic.** See Traffic Control Plan.

**B. Dense Graded Aggregate.** Do not furnish Crushed Stone Base in lieu of DGA.

**C. Jointed Plain Cement Concrete Pavement.** Use JPC Pavement. At Contractor's request and at no additional cost to the Department, the Engineer may approve other high early strength rapid setting concrete. The Department will allow either central mixing or truck mixing.

**D. Joint Sealant.** Use hot poured elastic, no alternates.

**E. Traffic Signal Loops.** See Special Notes for Traffic Signal Preformed Loop Replacement.

### III. CONSTRUCTION METHODS

**A. Maintain and Control Traffic.** See Traffic Control Plan.

**B. Site Preparation.** Be responsible for all site preparation, including but not limited to, incidental excavation and backfilling; removal of all obstructions or any other items; disposal of materials; sweeping and removal of debris; shoulder preparation and restoration; temporary and permanent erosion and pollution control; final dressing, clean

up, and seeding; and all incidentals. Perform all Site Preparation only as approved or directed by the Engineer.

**C. Pavement Removal.** Consider pavement removal locations and dimensions shown on the drawings to be approximate only; the Engineer will determine exact locations and dimensions at the time of construction. Prior to removal, saw-cut existing asphalt and/or concrete pavement at locations directed by the Engineer to provide a neat edge where new concrete will adjoin existing pavement. Remove existing asphalt and/or concrete pavement, underlying DGA or other stone base if necessary to provide for the specified thickness of the replacement JPC Pavement.

**D. Concrete Pavement Replacement.** Prior to pavement removal and placing JPC Pavement, obtain the Engineer's approval of proposed method of construction for ensuring and establishing a smooth profile. Immediately after removing asphalt pavement, stabilize the base as directed by the Engineer with DGA and place the replacement JPC in a continuous operation in accordance with the Traffic Control Plan Phasing and as directed by the Engineer. Construct the replacement JPC Pavement with a minimum depth of 10 inches; however, transition the finished grade to match adjacent pavement that is to remain in place; therefore, the actual thickness of the pavement may be greater than 10 inches in some areas. Consolidate the concrete, strike off, machine finish with a vibrating or roller screed, and straightedge the plastic concrete with a straightedge conforming to Section 501.02.18.

**E. Joint Sealing.** Saw, clean, and seal transverse and longitudinal joints as shown on the standard drawings and as directed the Engineer.

**F. Traffic Signal Loops.** See Special Notes for Traffic Signal Preformed Loop Replacement. Protect lead wires from each loop to the junction box during each phase of the construction sequence at no additional cost to the Department.

**G. Disposal of Waste.** Dispose of all cuttings, debris, and other waste off the right-of-way at sites obtained by the Contractor at no additional cost to the Department. See Special Note for Waste and Borrow.

**H. Pavement Markings.** See traffic Control Plan.

**I. On-Site Inspection.** Prior to submitting a bid, make a thorough inspection of the site and become thoroughly familiar with the existing conditions so that the work can be expeditiously performed after a contract is awarded. The Department will consider submission of a bid as evidence of this inspection having been made. The Department will not honor any claims resulting from site conditions.

**J. Property Damage and Restoration.** Be responsible for all damage to public and/or private property resulting from the work. Repair or replace all damaged roadway features in like kind materials and design at no additional cost to the Department. Repair or replace damaged private property in like kind materials and design to the satisfaction of the owner.

**K. Caution.** Consider information shown on the drawings and in this proposal and the types and quantities of work listed are approximate only, and not as an accurate or complete evaluation of the material and conditions to be encountered during construction. The bidder must draw his own conclusion as to the conditions encountered. The Department does not give any guarantee as to the accuracy of the data and no claim will be considered for additional compensation if the conditions encountered are not in accordance with the information shown.

**L. Utility Clearance.** Determine the location of all underground and overhead utilities prior to construction. It is not anticipated that utility facilities will need to be relocated and/or adjusted; however, in the event that work does require relocation and/or adjustment, the utility companies will work concurrently with the Contractor while relocating their facilities.

**M. Final Dressing, Clean Up, and Seeding and Protection.** After all work is completed, remove all waste and debris from the construction sites. Remove all temporary shoulder widening and restore disturbed shoulders. Perform Class A final dressing on all disturbed areas. Sow disturbed earthen areas with Seed Mixture No. 1.

**N. Coordination of Work.** Be advised that other projects may be in progress within or in the near vicinity of this project. Take into consideration that the traffic control of those projects may affect this project and the traffic control of this project may affect those projects. Coordinate the work on this project with the work of the other contractors. In case of a conflict, the Engineer will determine the relative priority to give to work phasing on the various projects.

#### IV. METHOD OF MEASUREMENT

The Department will measure only the bid items listed. All other items required to complete the construction shall be incidental to the listed bid items.

**A. Maintain and Control Traffic.** See Traffic Control Plan.

**B. Site Preparation.** Other than the bid items listed, site preparation will not be measured for payment, but will be incidental to the other items of the work.

**C. Remove Pavement.** The Department will measure removed asphalt pavement in square yards.

**D. JPC Pavement-10 IN.** See Section 502.04.01 and Section 501.04.01.

**E. Joint Sealing.** The Department will not measure Joint Sealing for payment, but shall be incidental to the bid item JPC Pavement-10 IN.

**F. Signal Loops.** See Special Notes for Traffic Signal Preformed Loop Replacement.

**G. Smooth Dowels, Deformed Tie Bars, and Hook Bolts.** The Department will not measure smooth dowels, deformed tie bars and hook bolts, but will be incidental to JPC Pavement-10 IN.

#### IV. BASIS OF PAYMENT

The Department will make payment only for the bid items listed. All other items required to complete the construction shall be incidental to the bid items listed.

**A. Maintain and Control Traffic.** See Traffic Control Plan.

**B. Remove Pavement.** Payment at the contract unit price per square yard shall be full compensation for saw cutting, milling and texturing, and removing existing pavement (asphalt and/or concrete); disposing of waste and debris.

**C. JPC Pavement-10 IN.** See Section 502.05.

**D. Signal Loops.** See Special Notes for Traffic Signal Preformed Loop Replacement.

### **SPECIAL NOTE – RIDE QUALITY**

The surface tolerance shall be such that there are no high/low spots greater than 1/8 inch in ten longitudinal feet, particularly at the interface between the new JPC pavement and adjacent slabs. The tolerance shall be checked with either a 10 foot rolling straight edge, stringline, or other 10 foot straight edge as deemed appropriate by the Engineer.

Pavement not meeting this tolerance will require corrective work, as directed by the Engineer, in order to resolve the ride quality issues. If areas are too low, removal and replacement at the contractor's expense may be required.

### **SPECIAL NOTE FOR STAKING**

In addition to the requirements of Section 201, perform the following:

1. Contrary to Section 201.03.01, perform items 1-3 usually performed by the Engineer; and
2. Verify intersection and lane profile and alignment and prepare a Drainage Development Worksheet to provide for positive drainage upon completion of construction; and
3. Prior to incorporating into the work, obtain the Engineers approval of all designs and revisions to be provided by the Contractor; and
4. Produce and furnish to the Engineer "As Built" plans; and
5. Perform any and all other staking operations required to control and construct the work.
6. Staking will not be measured for payment but will be considered incidental to other items of work.

### **Special Note for Armored Edge**

Install Armored Edges at locations on KY 74 and KY 2079 to provide positive separation between the JPC and asphalt. Armored Edges will be constructed with the JPC pavement the full width of each slab and shall not be continuous with adjacent slabs. Armored Edges will be 5/8" X 5" and shall conform to the design as indicated on Standard Drawing No. BJE-001-012. Armored Edges will be field measured and paid per each linear foot installed.

### **Special Note for Stamped Concrete**

Construct colored stamped imprinted concrete from curb to curb within the boundaries of the 12" White Thermoplastic cross walk pavement markings at the intersection of KY 2079 and KY 74. Color hardener shall be supplied using Brick Red color at 80 pounds per 100 SF, Deep Charcoal release agent at 4 pounds per 100 SF and Ashler Stone Texturing. The 6 ft strip of concrete to receive the stamped imprint shall be placed separately from other JPC areas as one continuous placement from curb to curb.



**Special Note for Colored Stamped Imprinted Concrete**  
**DRY-SHAKE COLORED HARDENER**  
**STAMPED/IMPRINTED CONCRETE PAVEMENT**

**PART 1 - GENERAL**

**1.1 SUMMARY**

- A. Drawings and general provisions of Proposal, apply to Work of this Section.
- B. Section Includes:
  - 1. Dry-shake colored hardener applied to sidewalks, roads, and other exterior concrete pavements.
  - 2. Stamping/Imprinting.
  - 3. Curing of colored and imprinted concrete.
- C. Related Sections:
  - 1. Concrete shall be supplied, placed, and delivered in accordance with Section 500 of Standard Specifications.
  - 2. Joint Sealants" for colored sealants for joints shall be hot poured elastic, no alternates.

**1.2 REFERENCES**

- A. American Concrete Institute (ACI):
  - 1. ACI 301 "Specification for Structural Concrete for Buildings."
  - 2. ACI 302 IR "Recommended Practice for Concrete Floor and Slab Construction."
  - 3. ACI 303.1 "Standard Specification for Cast-In-Place Architectural Concrete."
  - 4. ACI 304 "Recommended Practice for Measuring, Mixing, Transporting and Placing of Concrete."
  - 5. ACI 305R "Recommended Practice for Hot Weather Concreting."
  - 6. ACI 306R "Recommended Practice for Cold Weather Concreting."
- B. American Society of Testing and Materials (ASTM):
  - 1. ASTM C309 "Standard Specifications for Liquid Membrane-Forming Compounds for Curing Concrete."
  - 2. ASTM C494 "Standard Specification for Chemical Admixtures for Concrete."

### **1.3 SUBMITTALS**

- A. Product Data: Submit manufacturer's complete technical data sheets for the following:
  - 1. Dry-shake colored hardener.
  - 2. Powder antiquing release agent.
  - 3. Imprinting/Texturing tools.
  - 4. Curing compound.
- B. Design Mixes: For each type of concrete.
- C. Color hardener shall be supplied using Brick Red color; Deep Charcoal release agent to be supplied; and; Ashler Stone or Fractured Slate Texturing or imprinting tools to be used.

### **1.4 QUALITY ASSURANCE**

- A. Manufacturer Qualifications: Manufacturer with 10-years experience in manufacture of specified products.
- B. Installer Qualifications: An installer with 5 years experience with work of similar scope and quality.
- C. Comply with the requirements of ACI 301.
- D. Obtain each specified material from same source and maintain high degree of consistency in workmanship throughout Project.
- E. Notification of manufacturer's authorized representative shall be given at least 1-week before start of Work.
- F. Colored Concrete Mockups Field Samples:
  - 1. At location on Project selected by Engineer, place and finish 4 feet by 4 feet area.
  - 2. Construct mockup sample panel using processes and techniques intended for use on permanent work, including curing procedures. Include samples of control, construction, and expansion joints in sample panels. Mockup shall be produced by the individual workers who will perform the work for the Project.
  - 3. Accepted mockup provides visual standard for work of Section.
  - 4. Mockup Field sample shall remain through completion of the work for use as a quality standard for finished work.
  - 5. Remove mockup when directed.
  - 6. Mockup will not be paid for, but shall be considered incidental to Stamped Concrete.

### **1.5 DELIVERY, STORAGE, AND HANDLING**

- A. Deliver products in original factory unopened, undamaged packaging bearing identification of product, manufacturer, batch number, and expiration data as applicable.

- B. Store the product in a location protected from damage, construction activity, and precipitation in strict accordance with the manufacturer's recommendations.

## **1.6 PROJECT CONDITIONS**

- A. Schedule placement to minimize exposure to wind and hot sun before curing materials are applied.
- B. Avoid placing concrete if rain, snow, or frost is forecast within 24-hours. Protect fresh concrete from moisture and freezing.
- C. Comply with professional practices described in ACI 305R and ACI 306R.

## **1.7 PRE-JOB CONFERENCE**

- A. One week prior to placement of concrete, a meeting shall be held to discuss the Project and application methods.
- B. It is suggested that the Engineer, Subcontractor, Ready-Mix Concrete Representative, and a Manufacturer's Representative be present.

## **PART 2 - PRODUCTS**

### **2.1 ACCEPTABLE MANUFACTURER**

- A. L. M. SCOFIELD COMPANY, Douglasville, Georgia (800) 800-9900 or the appropriate local contact: Eastern Division – 201-672-9050; Western Division – 714-568-1870; Central Division Office – 630-377-5959.

### **2.2 MATERIALS**

- A. Dry-shake Colored Hardener: LITHOCHROME® Color Hardener; L. M. SCOFIELD COMPANY, factory proportioned, mixed, and packaged, ready-to-use surface hardener.
- B. [Stamping/Imprinting Tools and Materials:] LITHOTEX® Pavecrafters® imprinting tools; L. M. SCOFIELD COMPANY.
- C. [Powder Antiquing Release Agent:] LITHOCHROME® Antiquing Release; L. M. SCOFIELD COMPANY.
  - 1. Powder antiquing release agent shall be recommended by pattern tool manufacturer and compatible with dry-shake colored hardener.

- D. Curing and Sealing Compound: SCOFIELD® Cureseal-W™ [Semi Gloss] and Cureseal-S™ [Gloss]; L. M. SCOFIELD COMPANY. Curing and sealing compound shall comply with ASTM C309 and be of same manufacturer as colored admixture, for use with integrally colored concrete.
- E. SUBSTITUTIONS: The use of products other than those specified will be considered providing that Contractor requests its use in writing within 14-days prior to use. This request shall be accompanied by the following:
  - 1. A certificate of compliance from material manufacturer stating that proposed products meet or exceed requirements of this Section.
  - 2. Documented proof that proposed materials have a 10-year proven record of performance confirmed by at least 5 local projects that Engineer can examine.

### **2.3 COLORS [AND PATTERNS]**

- A. Colors: Dry Shake Color Hardner as selected by Engineer from Scofield Color Chart A-112.08 LITHOCHROME Color Hardener: Brick Red.
- B. Imprinting patterns as selected by Engineer from Scofield LITHOTEX® Pavecrafters™ Pattern Sheets. Ashler Stone or Fractured Slate.
- C. Powder Antiquing Release Agent: As selected by Engineer from manufacturer's standard colors: Deep Charcoal.

### **2.4 CONCRETE MIX DESIGN**

- A. Minimum Cement Content: 5 sacks per cubic yard of concrete.
- B. Slump of concrete shall be consistent throughout Project at 4-inches or less. At no time shall slump exceed 5-inches. If super plasticizers are allowed, slump shall not exceed 8-inches. Superplasticizers are encouraged to open traffic timely.
- C. Do not add calcium chloride to mix as it causes mottling and surface discoloration.
- D. Supplemental admixtures shall not be used unless approved by manufacturer.
- E. Do not add water to the mix in the field.
- F. Maximum air content shall not exceed 5 percent.

## **PART 3 - EXECUTION**

### **3.1 CONCRETE PLACEMENT**

- A. Move concrete into place with square-tipped shovels or concrete rakes.

- B. Vibrators, when used, shall be inserted and withdrawn vertically.
- C. Concrete shall be struck to specified level with wood or magnesium straight edge or mechanical vibrating screed.
- D. The concrete surface shall be further leveled and consolidated with highway magnesium straight edge and/or magnesium bull float.
- E. Mechanically float concrete surfaces as soon as concrete surface has taken its initial set and will support weight of a power float machine equipped with float shoes or combination blades and operator.

### **3.2 INSTALLATION**

- A. Apply 2/3 of specified application rate to freshly floated concrete surface. Bleed water shall not be present during or following application of first and second shake.
- B. Do not throw dry-shake; Broadcast in order to distribute evenly by hand or mechanical spreader designed to apply floor hardeners. Consult L. M. Scofield Company for recommended manufacturers of mechanical spreaders.
- C. As soon as dry-shake material has absorbed moisture, indicated by uniform darkening of surface, mechanically float concrete surface a second time, just enough to bring moisture from base slab through dry-shake color hardener.
- D. Immediately following second floating, apply remaining 1/3 of specified application rate. If applied by hand, broadcast in opposite direction of first application for a more uniform coverage. If a mechanical spreader is used, apply the same manner as previously described.
- E. As soon as dry-shake material has absorbed moisture, mechanically float concrete surface a third time. Perform additional troweling as needed to prepare a smooth flat concrete surface. Perform edging around form edges and joints if necessary.
- F. Do not add water to the surface.
- G. When concrete has set sufficiently to imprint, Begin imprinting operations immediately after applying Antiquing Release Agent, according to manufacturer's written instructions, including application of powder antiquing release agent. Broadcast lightly and evenly across surface of color concrete.

### **3.3 CURING**

- A. Wet cure for 12 hours minimum.

- B. When concrete has set sufficiently, after imprinting and concrete has set sufficiently, blow or vacuum excess release agent from concrete. Lightly pressure wash surface to remove excess release agent. This step is required.
- C. Imprinted concrete shall be cured with liquid membrane curing and sealing compound as recommended by manufacturer.
- D. There should be no free water on the surface at time of application.

### **3.4 PROTECTION OF FINISHED WORK**

- A. Protect finish work
- B. Prohibit foot or vehicular traffic on the newly imprinted concrete surface.
- C. Barricade area to protect newly imprinted concrete.

### **3.6 APPLICATORS**

- A. For a list of qualified contractors, contact your local L. M. Scofield Company representative or the appropriate Division Office: Eastern Division – 201-672-9050; Western Division – 714-568-1870; Central Division Office – 630-377-5959.

## **PART 4 – METHOD OF MEASUREMENT**

The Department will measure only the bid items listed. All other items required to complete the construction shall be incidental to the listed bid items.

- A. Maintain and Control Traffic.** See Traffic Control Plan.
- B. Site Preparation.** Other than the bid items listed, site preparation will not be measured for payment, but will be incidental to the other items of the work.
- C. Color Hardener.** The Department will not measure Color Hardener for payment, but shall be incidental to the bid item Stamped Concrete.
- C. Stamped Concrete.** The Department will measure Stamped Concrete in square yards.
- D. JPC Pavement-10 IN.** See Section 502.04.01 and Section 501.04.01.
- E. Joint Sealing.** The Department will not measure Joint Sealing for payment, but shall be incidental to the bid item JPC Pavement-10 IN.
- F. Signal Loops.** See Special Notes for Traffic Signal Preformed Loop Replacement.

**G. Smooth Dowels, Deformed Tie Bars, and Hook Bolts.** The Department will not measure smooth dowels, deformed tie bars and hook bolts, but will be incidental to JPC.

## **PART 5 – BASIS OF PAYMENT**

The Department will make payment only for the bid items listed. All other items required to complete the construction shall be incidental to the bid items listed.

**A. Maintain and Control Traffic.** See Traffic Control Plan.

**B. Stamped Concrete.** Payment at the contract unit price per square yard shall be full compensation for constructing the mockup, coloring, mixing and placing stamped concrete.

**C. JPC Pavement-10 IN.** See Section 502.05.

**D. Signal Loops.** See Special Notes for Traffic Signal Preformed Loop Replacement

*Special Note for Colored Stamped Imprinted Concrete.doc*

**FD04 007 2079 001-002 JPC intersection Dimensions and Area Summary**

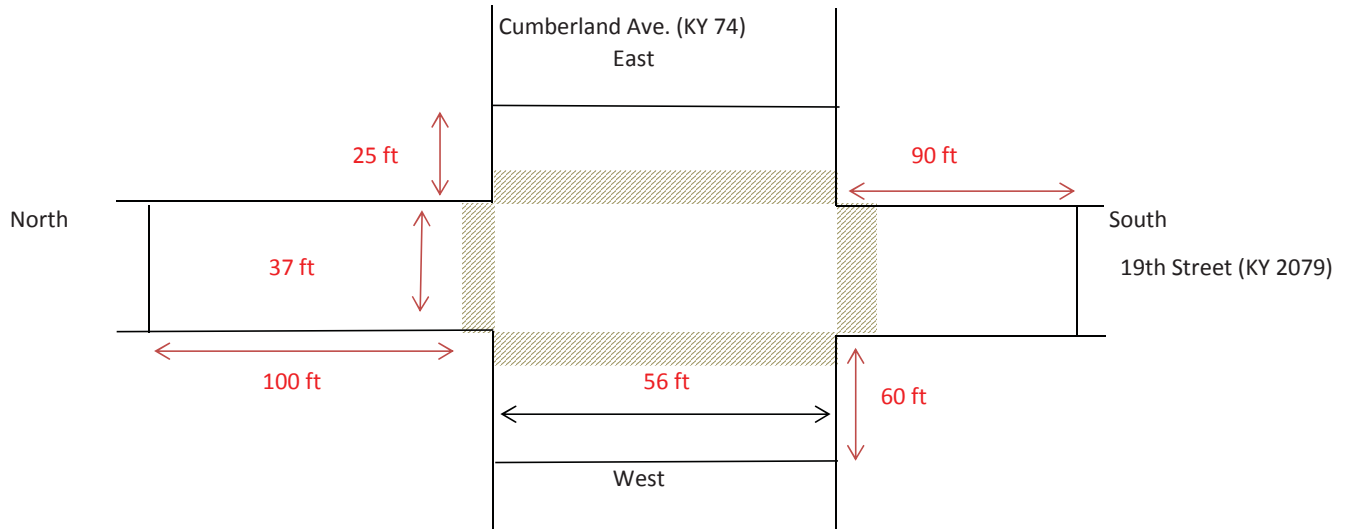

	Length	Width	Area (SY)
Body of Intersection	37	56	230.2222
East Side of Intersection	25	56	155.5556
West Side of Intersection	60	56	373.3333
North Side of Intersection	100	37	411.1111
South Side of Intersection	90	37	370
<b>Total</b>			<b>1540.222</b>

Stamped Concrete Area	Length	Width	Area (SY)
East KY 74 crosswalk	56	6	37.33333
West KY 74 crosswalk	56	6	37.33333
North 19th st. crosswalk	37	6	24.66667
South 19th st. crosswalk	37	6	24.66667
<b>Total</b>			<b>124</b>



## **Project Phasing (FD04 SPP 007 2079 001-002)**

KY 2079 (19<sup>th</sup> street) will be closed for the duration of the project at the KY 74 intersection. Traffic will be detoured onto 18<sup>th</sup> street. KYTC will sign the detour.

### **Phase 1-5 (KY 74)**

Lane closures to be set up on KY 74, establish two- way traffic on KY 74.

Phase 1 - WB RT lane

Phase 2 - WB LT lane

Phase 3 - Lt Turn lane

Phase 4 - EB LT lane

Phase 5 - EB RT lane

### **Phase 6-9 (KY 2079)**

Phase 6 - SB KY 2079 on North Side of Intersection

Phase 7 - NB KY 2079 on North Side of Intersection

Phase 8 - SB KY 2080 on South Side of Intersection

Phase 9 - NB KY 2079 on South Side of Intersection

The phasing listed above is only a suggestion; the contractor may propose a different pouring sequence. KYTC requires that JPC pours on KY 74 be made completely through the body of the intersection, minimizing the construction joints. Pours shall be made to maintain existing crown of roadway to ensure proper drainage. Two- way traffic shall be open on KY 74 and KY 2079 can be detoured for the duration of the project

**PROPOSAL BID ITEMS**

142130

Report Date 5/27/14

**Section: 0001 - PAVING**

LINE	BID CODE	ALT	DESCRIPTION	QUANTITY	UNIT	UNIT PRICE	FP	AMOUNT
0010	00190		LEVELING & WEDGING PG64-22	417.00	TON		\$	
0020	00301		CL2 ASPH SURF 0.38D PG64-22	495.00	TON		\$	
0030	00388		CL3 ASPH SURF 0.38B PG64-22	7,725.00	TON		\$	
0040	02014		BARRICADE-TYPE III	4.00	EACH		\$	
0050	02024		JPC PAVEMENT-10 IN/24	1,541.00	SQYD		\$	
0060	02091		REMOVE PAVEMENT	1,541.00	SQYD		\$	
0070	02562		TEMPORARY SIGNS	1,200.00	SQFT		\$	
0080	02650		MAINTAIN & CONTROL TRAFFIC (FD05)	1.00	LS		\$	
0090	02650		MAINTAIN & CONTROL TRAFFIC (FD04)	1.00	LS		\$	
0100	02671		PORTABLE CHANGEABLE MESSAGE SIGN	4.00	EACH		\$	
0110	02676		MOBILIZATION FOR MILL & TEXT (FD05)	1.00	LS		\$	
0120	02676		MOBILIZATION FOR MILL & TEXT (FD04)	1.00	LS		\$	
0130	02677		ASPHALT PAVE MILLING & TEXTURING	7,335.00	TON		\$	
0140	02720		SIDEWALK-4 IN CONCRETE	102.00	SQYD		\$	
0150	02775		ARROW PANEL	2.00	EACH		\$	
0160	03299		ARMORED EDGE FOR CONCRETE	190.00	LF		\$	
0161	23379EC		STAMPED CONCRETE ADDED: 5-27-14	124.00	SQYD		\$	
0170	04830		LOOP WIRE	7,224.00	LF		\$	
0180	04894		PREFORMED LOOP/LEAD-IN	60.00	LF		\$	
0190	04895		LOOP SAW SLOT AND FILL	3,042.00	LF		\$	
0200	06510		PAVE STRIPING-TEMP PAINT-4 IN	72,650.00	LF		\$	
0210	06514		PAVE STRIPING-PERM PAINT-4 IN	54,700.00	LF		\$	
0220	06566		PAVE MARKING-THERMO X-WALK-12 IN	3,397.00	LF		\$	
0230	06568		PAVE MARKING-THERMO STOP BAR-24IN	715.00	LF		\$	
0240	06573		PAVE MARKING-THERMO STR ARROW	2.00	EACH		\$	
0250	06574		PAVE MARKING-THERMO CURV ARROW	38.00	EACH		\$	
0260	06575		PAVE MARKING-THERMO COMB ARROW	3.00	EACH		\$	
0270	06591		PAVEMENT MARKER TYPE V-BY	528.00	EACH		\$	
0280	10020NS		FUEL ADJUSTMENT	13,445.00	DOLL	\$1.00	\$	\$13,445.00
0290	10030NS		ASPHALT ADJUSTMENT	33,768.00	DOLL	\$1.00	\$	\$33,768.00
0300	20453ES835		PREFORMED QUADRAPOLE LOOPS	204.00	LF		\$	
0310	23158ES505		DETECTABLE WARNINGS (RETROFIT EXISTING SIDEWALK RAMPS)	416.00	SQFT		\$	
0320	23158ES505		DETECTABLE WARNINGS (NEW SIDEWALK RAMPS)	224.00	SQFT		\$	

**Section: 0002 - DEMOBILIZATION**

LINE	BID CODE	ALT	DESCRIPTION	QUANTITY	UNIT	UNIT PRICE	FP	AMOUNT
0330	02569		DEMOBILIZATION	1.00	LS		\$	